

BEFORE THE BOARD OF COUNTY COMMISSIONERS OF LANE COUNTY, OREGON

ORDER NO: 15-11-10-05

IN THE MATTER OF RELEASING AND DEDICATING  
PARCEL "A" OF THE PLAT OF IRVINGTON PLACE,  
AS RIGHT OF WAY FOR ARGON AVENUE  
(17-04-02-34)

**WHEREAS**, by previous action the following land, located within the City of Eugene and described as Parcel "A" of the plat of Irvington Place, as platted on Book 57, Page 18, Lane County, Oregon Plat Records, was conveyed to Lane County, Oregon by that certain deed, recorded on Reel 461-R, Recorder's Reception Number 88923, Lane County, Oregon Deed Records; and

**WHEREAS**, the City of Eugene Public Works Department has requested that the parcel strip be released and dedicated for road purposes to allow access to newly created lots within the plat of Addyson Creek as recorded on Instrument Number 2015-052079; and

**WHEREAS**, at the time Irvington Place was platted, Parcel "A" was outside the city limits and conveyed to Lane County to hold in public trust. Parcel "A" has since been annexed into the City. Lane County will release the strip and dedicate it as public right of way on the condition the City of Eugene approves and accepts the deed; and

**WHEREAS**, the Director of Lane County Public Works has provided a written report marked as Exhibit "A", determining that the special benefit to the applicant is de minimis pursuant to Lane Manual 60.854 (8)(c); and

**WHEREAS**, said parcel need no longer remain as a parcel of county owned real estate, but should be dedicated for road purposes.

**NOW, THEREFORE**, the Board of County Commissioners of Lane County **ORDERS** as follows:

1. The real estate, as described in the attached Draft Dedication marked as Exhibit "B", and depicted on the attached map marked as Exhibit "C", be released and dedicated as public right of way on the condition the dedication be accepted by the City of Eugene.
2. The Board Chair is authorized to execute an original Dedication of Public Road Easement on behalf of the County.

3. This Order will be entered into the records of the Board of County Commissioner's Journal of Administration and the attached Dedication be recorded in the Lane County Oregon Deed Records, and the document number be noted on this Order.

ADOPTED this 10th day of November, 2015.

Department of Public Works  
Engineering and Construction Services Division

LANE COUNTY BOARD OF  
COMMISSIONERS

Approved October 27, 2015

By Bill Morgan  
Bill Morgan, County Engineer

By Jay Bozievich for  
Jay Bozievich, Chair

APPROVED AS TO FORM

Date 11/10/15

LANE COUNTY OFFICE OF LEGAL COUNSEL

Dedication Recorded on Document No. \_\_\_\_\_, Lane County, Oregon  
Deed Records.

## DEDICATION OF A PUBLIC ROAD EASEMENT

### LANE COUNTY

KNOW ALL MEN BY THESE PRESENTS, that Lane County (Grantor), a political subdivision of the State of Oregon, is the owner of certain real property, located in Section 2, Township 17 South, Range 4 West of the Willamette Meridian and that Lane County acquired title by that certain Bargain and Sale Deed from Robert W. Johnston and Ruth A. Johnston, husband and wife, Grantors, recorded on Reel 461R, Recorder's Reception Number 88923 of the Lane County, Oregon Deed Records, and that said Lane County does hereby dedicate to the free use of the Public (Grantee), for public road purposes, the following described tract of land, to wit:

Parcel "A" of Irvington Place, as platted and recorded in Book 57, Page 18, Lane County, Oregon Plat Records, in Lane County, Oregon.

It being the intent to release and dedicate the one-foot reserve strip (Parcel "A" of Irvington Place) as public right of way for Argon Avenue, upon condition this dedication be accepted and approved by the City of Eugene.

There is no consideration for this dedication.

Approved this 10<sup>th</sup> day of November, 2015

  
\_\_\_\_\_  
Jay Bozievich, Chair  
Lane County Board of Commissioners

STATE OF OREGON )  
COUNTY OF LANE ) ss.

On November 10<sup>th</sup>, 2015, personally appeared the  
above-named ~~Jay Bozievich~~, as Chair of the Lane County Board of Commissioners  
and acknowledged the foregoing instrument to be his voluntary act before me.

Faye Stewart  
DJ

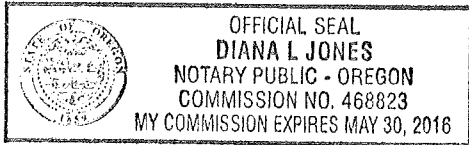

  
\_\_\_\_\_  
NOTARY PUBLIC FOR OREGON  
My Commission Expires: 5/30/16

The City of Eugene approves and accepts this dedication as described herein.

City of Eugene

By \_\_\_\_\_

Title \_\_\_\_\_

EXHIBIT "A"

MAP No.: 17-04-02-31-01500

**LANE COUNTY**

Notification of an Estimated Value of the Special Benefit Deposit  
in Connection with a Proposed Release and Public Road Dedication of an Access Control Strip  
Pursuant to Lane Manual 60.854(8)(c)

Pursuant to the provisions of Lane Manual 60.854(8)(c), my determination of the amount of "Special Benefit" and therefore the amount of deposit required in connection with the proposed release of an access control strip known as Parcel "A," of the Plat of Irvington Place as Platted and Recorded in Volume 57, Page 18, Lane County Plat Records in Lane County, Oregon, is **\$0.00**.

My determination is based on a Staff Report and recommendation, a copy of which is attached hereto and marked as "Attachment 1".

Dated this 30 day of September, 2015.



---

Marsha A. Miller, Director  
Lane County Public Works

## STAFF REPORT

Recommendation in the Matter of an Estimation of the Special Benefit Deposit  
in Connection with a Proposed Release and Public Road Dedication of an Access Control Strip  
Pursuant to Lane Manual 60.854(8)(c)

**Date:** September 24, 2015

**Applicant:** Fam-Lee, LLC, an Oregon Limited Liability Company

### **Proposed Release and Public Road Dedication:**

The proposed release and subsequent public road dedication of the access control strip is described as Parcel "A," of the Plat of Irvington Place as Platted and Recorded in Volume 57, Page 18, Lane County Plat Records in Lane County, Oregon. The Parcel is 1 foot by 294.49 feet and runs along the northern boundary of Argon Avenue. It is held by Lane County in trust for the benefit of the People of Lane County in Bargain and Sales Deed dated November 19, 1969.

The release and subsequent public road dedication of the access control strip is a request being made in conjunction with the City of Eugene approved subdivision plat named Addyson Creek, on Map and Tax Lot 17-04-02-31-01500. The Addyson Creek subdivision will be accepted and officially platted prior to the release and subsequent public road dedication of the access control strip. The effect of the release and public road dedication will widen Argon Avenue from an approximately 30 foot public right of way to an approximately 60 to 65 foot public right of way. The Special Benefit Estimation is made on the assumption that Addyson Creek is platted and recorded.

### **Tax Lots Adjacent to Proposed Release and Public Road Dedication:**

Tax Map and Lot No's adjacent to the strip prior to the plat approval include 17-04-02-34-13900 and 17-04-02-34-14002 on the south side of Argon Avenue and 17-04-02-31-01500 on the north side of Argon Avenue. These tax lots represent Lot 7, Block 1 and Lot 7, Block 2 of the Plat of Irvington Place on the south side of Argon Avenue and Lots 18 through 21 of the proposed Addyson Creek Subdivision on the north side of Argon Avenue, respectively.

### **Nature of Benefit to be Received if Proposed Release and Public Road Dedication is Approved:**

*Lane Manual 60.854(8)(b) "In addition to payment of the fees specified in subsection (8)(a) above, the release and dedication of access control strips by the County governing body shall require payment by the applicant of a deposit equal to the estimate of special benefit that results from the action to the benefitted property owners."*

#### **1. Special Benefit Defined:**

Lane Manual does not define the term "Special Benefit"; however, in appraising acquisitions for right of way, a special benefit is defined as "*advantages arising from a public improvement for which property has been acquired under eminent domain accruing directly and solely to the advantage of the property remaining after the partial acquisition.*" This definition does not include a general benefit which is defined as a benefit "*accruing to the community at large, to the area adjacent to the improvement, or to*

## "ATTACHMENT 1" OF EXHIBIT "A"

*other property similarly situated as that acquired but which is not acquired.*" In Oregon, a "Special Benefit" is used to offset damages caused by the acquisition (See ODOT Right of Way Manual 4.310).

Although special and general benefit definitions apply to acquisitions through eminent domain, the Right of Way staff applies the same principles to the definition of a "Special Benefit" for the release and public road dedication of an access control strip. When used in the context of a release and a public road dedication of an access control strip, a practical definition follows:

*"The advantages arising from the release and subsequently public road dedication for which the property, created under the terms of the conveying document and through the regulatory provisions of Lane County's subdivision ordinance, accruing directly and solely to the advantage of the property after the release and subsequent public road dedication."*

If a special benefit exists, it is offset by inverse damages, also known as development costs. Some of those costs include permits, engineering, construction, the land dedicated through the platting of the subdivision, and the cost to release and dedicate the access control strip.

### **2. Special Benefit to Evaluate:**

The Public presently has a possessory interest in the reserve strip held in trust by Lane County to restrict access in accordance with the subdivision ordinance and to "*dedicate said property or part thereof as a public road....*" The proposed release of the reserve strip will be in conjunction with the dedication of a right of way that will allow travel over and across the strip of land. This action will result in legal access by widening the street from approximately 30 feet to 60 and 65 feet.

### **3. Special Benefit to Property Owner(s):**

A clear, plain reading of LM 60.854(8)(b) gives no indication to which property owner is to receive the special benefit. Potentially, it could be any number of adjacent properties including the underlining fee owner. According to the conveying deed, once the dedication is authorized by the Planning Commission, "this trust shall terminate with respect to the property or part thereof so dedicated." In other words, the possessory interest will revert back to the underlying fee owner only to be burdened by a public right of way. With the dedication and improvement of a wider road, it is clear that all the adjacent property owners will receive a benefit from the project.

### **4. Special Benefit Evaluation/Highest and Best Use:**

The test for estimating a special benefit must be specific and measurable, which can be justified through an increase in market value due to change in a more profitable use. Using the "Highest and Best Use" concept in conjunction with the "Before and After" rule is the most appropriate method for determining a "Special Benefit." It is the opinion of Right of Way staff that the Highest and Best Use before and after the release and subsequent public road dedication of each adjacent property is and will be residential.

Using the "Before and After" method, Right of Way staff performed market research that included review of comparable sales as well as interviews with local real estate professionals and other jurisdictions. From this information, staff has found that the market largely ignores the presence of an access control strip in its buying decision unless it cannot be released. Furthermore, staff has concluded that there is no specific or measurable difference in sales price between properties sold with or without an access control strip.

**Summary and Recommendation of Special Benefit:**

*Lane Manual 60.854(8)(b) The estimated value of the special benefit and the amount of money to be deposited shall be determined by the Public Works Director. In the event of an estimated special benefit value of less than \$2,500, it shall be considered de minimis and a payment of deposit for special benefit shall not be required..*

The relevant factors used to determine a "Special Benefit" have been examined. The subdivision lots along Argon Avenue will receive a general benefit of a widened street. There is no evidence that the release and public road dedication of the access control strip will cause any one subdivision lot or property to change to a more profitable use. Thus, any advantages arising from the release of the Public's possessory interest and subsequent public road dedication will be of a general nature and not specifically accruing directly and solely to the advantage of any subdivision lot or property.

Pursuant to Lane Manual 60.854, a special benefit must be determined. The release of the possessory interest in exchange for a publically dedicated right of way will not produce a "Special Benefit" to adjoining subdivision lots and owners. As the value added is less than the \$2,500 *de minimus value* required by Lane Manual 60.854(8)(c), the appraiser concludes that a payment for Special Benefit is not warranted for this release.

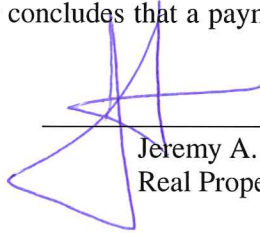
  
\_\_\_\_\_  
Jeremy A. Sherer  
Real Property Officer



**CITY OF EUGENE APPROVED ADDYSON CREEK SUBDIVISION**

Showing Addyson Creek and Irvington Place Lots



**GOOGLE STREET VIEW**

Showing Argon Street looking east from Byron

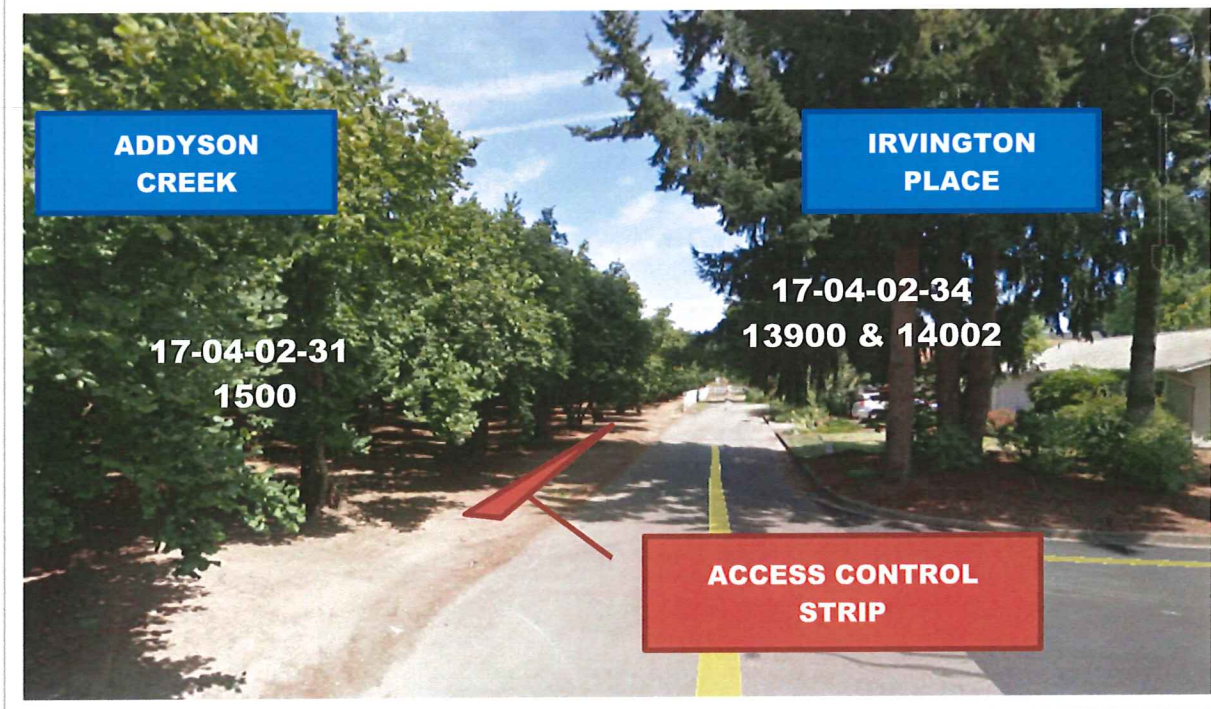

EXHIBIT "B"

**DEDICATION OF A PUBLIC ROAD EASEMENT**

**LANE COUNTY**

KNOW ALL MEN BY THESE PRESENTS, that Lane County (Grantor), a political subdivision of the State of Oregon, is the owner of certain real property, located in Section 2, Township 17 South, Range 4 West of the Willamette Meridian and that Lane County acquired title by that certain Bargain and Sale Deed from Robert W. Johnston and Ruth A. Johnston, husband and wife, Grantors, recorded on Reel 461R, Recorder's Reception Number 88923 of the Lane County, Oregon Deed Records, and that said Lane County does hereby dedicate to the free use of the Public (Grantee), for public road purposes, the following described tract of land, to wit:

Parcel "A" of Irvington Place, as platted and recorded in Book 57, Page 18, Lane County, Oregon Plat Records, in Lane County, Oregon.

It being the intent to release and dedicate the one-foot reserve strip (Parcel "A" of Irvington Place) as public right of way for Argon Avenue, upon condition this dedication be accepted and approved by the City of Eugene.

There is no consideration for this dedication.

Approved this \_\_\_\_\_ day of \_\_\_\_\_, 2015

\_\_\_\_\_  
Jay Bozievich, Chair  
Lane County Board of Commissioners

STATE OF OREGON )  
COUNTY OF LANE ) ss.

On \_\_\_\_\_, 2015, personally appeared the above-named Jay Bozievich, as Chair of the Lane County Board of Commissioners and acknowledged the foregoing instrument to be his voluntary act before me.

\_\_\_\_\_  
NOTARY PUBLIC FOR OREGON  
My Commission Expires: \_\_\_\_\_

The City of Eugene approves and accepts this dedication as described herein.

City of Eugene

By \_\_\_\_\_

Title \_\_\_\_\_

DRAFT

# RELEASE AND DEDICATION PARCEL 'A' OF IRVINGTON PLACE PORTION OF ARGON AVENUE

SW ¼ Section 2, T. 17 S., R. 4 W. W.M. Lane County



NO SCALE

